

PERIFIC max

The smart energy meter that optimizes and monitors your EV charging and overall power consumption.



Optimize EV Charging,
Save Money



20+ Supported
EV Charger Brands



Fuse Protection



Multi-point Measuring



Works With Any
Facility Type

PERIFIC

perific.com

LAN Adapter is an accessory that needs to be purchased separately

Extended Wi-Fi Antenna is an accessory that needs to be purchased separately

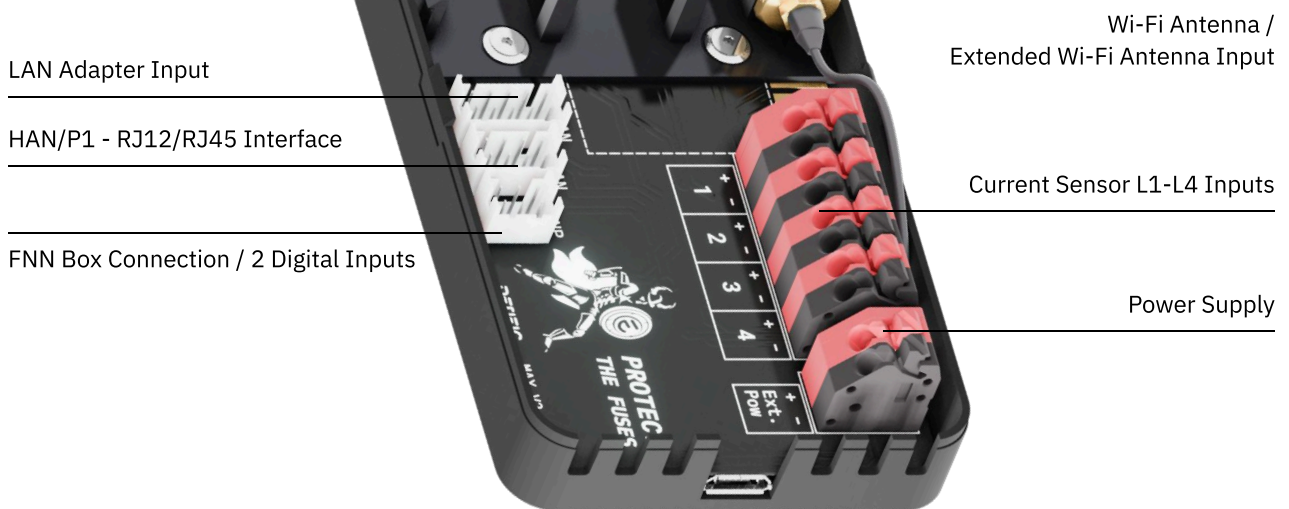

Tech specs

- Advanced Power Management
- L1, L2, L3 Real-time data
- Solar energy (L4) Real-time data
- Wi-Fi 2,4 GHz b/g/n
- LAN
- HAN/P1 - RJ12 Real-time data
- HAN/P1 - RJ45 Real-time data
- Power Supply: RJ12 / 5V DC / 12V DC
- IP Class: IP20
- Temp. Range: -40 °C ~ +65 °C
- Dimensions: 110 mm x 59 mm x 27 mm
- Weight: 99 g
- Packaging Dimensions: 140 mm x 80 mm x 85 mm
- Packaging Weight: 315 g

Functions & Compatibility

- Power Usage Measuring
- Solar Energy Measuring
- Track and Optimize EV Charger
- Solar EV Charging
- Price/Tariff Adapted EV Charging
- Custom Scheduled EV Charging
- Multi-point Measuring
- Large Facilities without Energy Meters
- Small Facilities with Energy Meters

PERIFIC

Current Sensors

Perific's Current Sensors are attached around the phase conductors for measuring real-time data.



Easy snap-on installation



Solar measuring



Multi-point measuring



0 A - 2500 A

PERIFIC

perific.com

Compatible with:



Perific Max

Current Sensors

Ø 16 mm Sensor Kit



- Current range: 0-900 A
- Cable length per sensor: 2000 mm
- Compatibility: Perific Max
- 50mV/kA@50Hz | Accuracy: 0,5%

Current directional input is not supported with Perific Max.

Ø 36 mm Sensor Kit



- Current range: 0-900 A
- Cable length per sensor: 2000 mm
- Compatibility: Perific Max
- 50mV/kA@50Hz | Accuracy: 0,5%

Current directional input is not supported with Perific Max.

Ø 100 mm Sensor Kit



- Current range: 0-900 A
- Cable length per sensor: 2000 mm
- Compatibility: Perific Max
- 50mV/kA@50Hz | Accuracy: 0,5%

Current directional input is not supported with Perific Max.

Ø 100 mm HC Sensor Kit



- Current range: 0-2500 A (High Current)
- Cable length per sensor: 2000 mm
- Compatibility: Perific Max
- 20mV/kA@50Hz | Accuracy: 0,5%

Current directional input is not supported with Perific Max.

The sensors can be easily opened and closed around the phase conductors, with the other end connected directly to the terminal inputs on the Perific Max.

1. Installation

Electrical meter | HAN/P1 RJ12, RJ45

⚠ Before you start

Note that this product is installed on an electricity meter to measure the property's energy usage and needs to be within the range of a 2.4 GHz Wi-Fi network. Some electricity meters do not provide power through the HAN/P1 port. In such cases, you will need to purchase a USB or DIN adapter to power the One, and ensure there is an electrical outlet within two meters of the planned installation site. Carefully follow the steps in this guide for correct installation.

Ensure the electricity meter has a HAN/P1 port with an RJ12 or RJ45 connection type.

Ensure the HAN/P1 port is activated by the grid owner.

Innan du sätter igång

Notera att denna produkt installeras elmätare för att mäta fastighetens energianvändning och behöver installeras inom räckvidden för ett 2,4 GHz Wi-Fi. Vissa elmätare levererar inte ström genom HAN/P1-porten. I så fall behöver du köpa till USB- eller DIN-adaptör för att strömsätta One och därmed se till att det finns ett eluttag inom två meters avstånd från den planerade installationsplatsen. Följ noggrant stegen i denna guide för korrekt installation.

Säkerställ att elmätaren har en HAN/P1-port av anslutningstypen RJ12 eller RJ45.

Säkerställ att HAN/P1-porten är aktiverad hos elnätsägaren.

Ennen kuin aloitat

Huomaa, että tämä tuote asennetaan sähkömittariin kiinteistön energiankulutuksen mittaamiseksi ja sen on oltava 2,4 GHz Wi-Fi-verkon kantaman sisällä. Jotkin sähkömittarit eivät tarjoa virtaa HAN/P1-portin kautta. Tällaisessa tapauksessa sinun on hankittava USB- tai DIN-adaptteri One-laitteen virransyöttöä varten ja varmistettava, että suunnitellun asennuspaikan lähellä on sähköpistoke enintään kahden metrin etäisyydellä. Noudata huolellisesti tämän oppaan ohjeita oikean asennuksen varmistamiseksi.

Varmista, että sähkömittarissa on RJ12/RJ45-liitintyyppinen HAN/P1-portti.

Varmista, että HAN/P1-portti on aktivoitu sähköverkon omistajan toimesta.

Før du begynner

Merk at dette produktet installeres på en strømmåler for å måle eiendommens energiforbruk og må være innen rekkevidde for et 2,4 GHz Wi-Fi-nettverk. Noen strømmålere leverer ikke strøm gjennom HAN/P1-porten. I så fall må du kjøpe en USB- eller DIN-adaptør for å strømforsyne One, og sørge for at det er en stikkontakt innen to meter fra den planlagte installasjonsplassen. Følg nøye trinnene i denne guiden for korrekt installasjon.

Sørg for at strømmåleren har en HAN/P1-port med RJ12/RJ45-tilkoblingstype.

Sørg for at HAN/P1-porten er aktivert av netteieren.

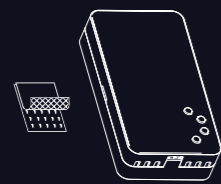

1 X Max



1 X License

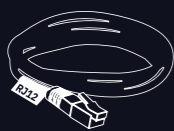

1 X RJ12 Cable

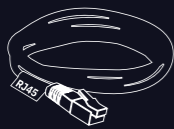

1 X RJ45 Cable



1 X DIN / USB Adapter

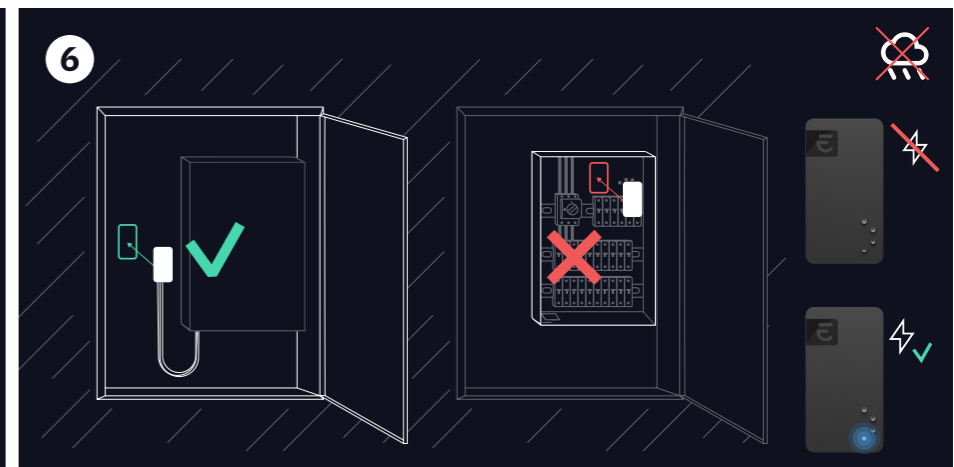
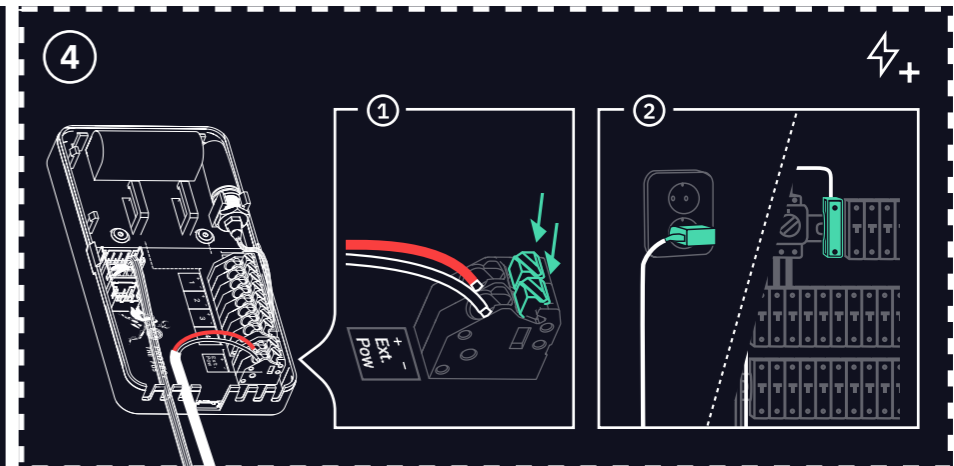
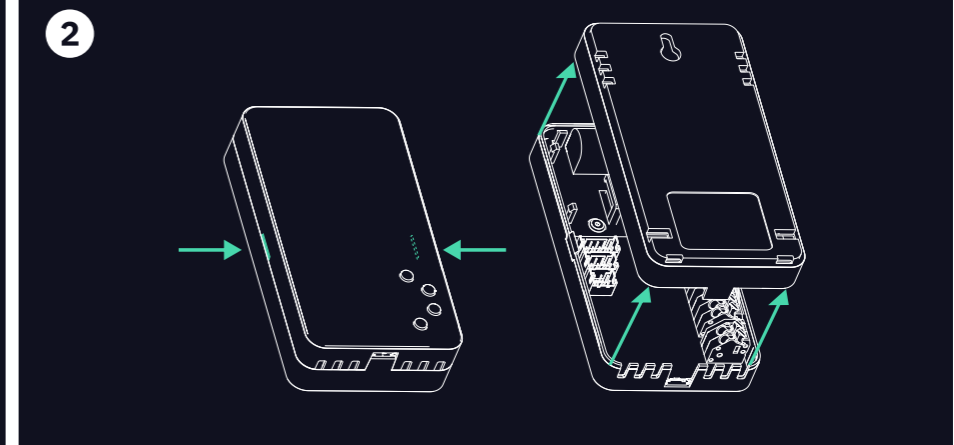
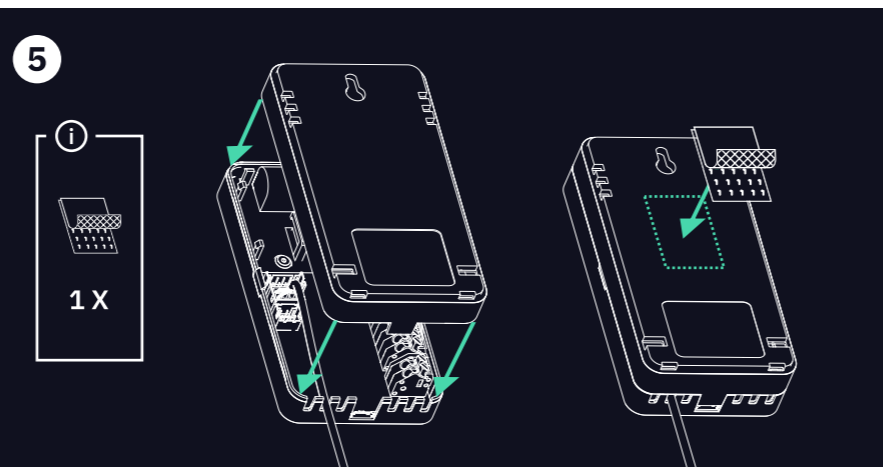
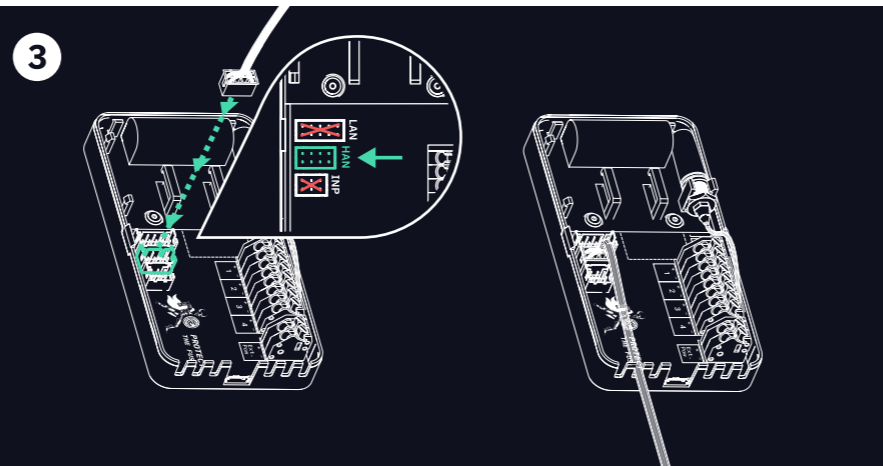
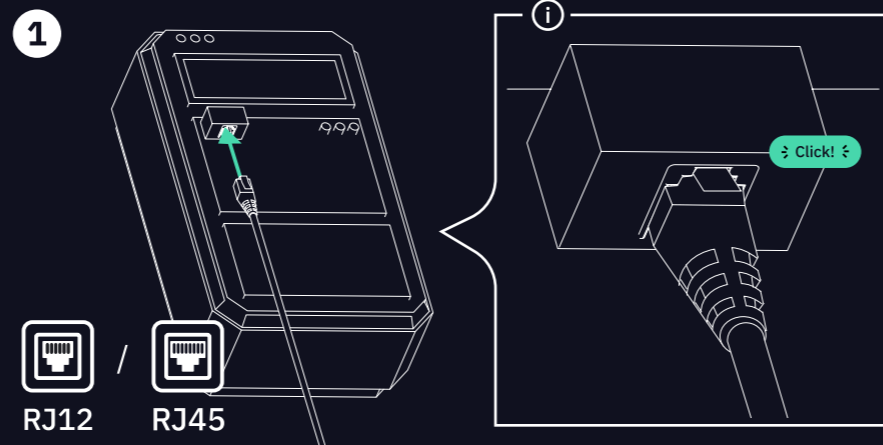



en.perific.com/register-admin

No Installer Account? Get It Here!

Inget installatörskonto? Skaffa här!

Ei asentajatiiliä? Hanki se täältä!

Ingen installatørkonto? Få det her!

2. Set Up Account and Device in App

Log in with installer account
Logga in med installatörskonto
Kirjautu sisään asennustilillä
Logg inn med installatørkonto

Create or log in to the users account
Skapa eller logga in på användarkonto
Luo tai kirjautu käyttäjän tiliin
Opprett eller logg inn på brukerens konto

Add new device
Lägg till ny enhet
Lisää uusi laite
Legg til ny enhet

Complete the steps
Följ anvisningarna
Seuraa vaiheita.
Følg trinnene.

3. Set Up Power Control for EV Charger ?

Go to Settings, Licenses
Gå till Inställningar, Licenser
Mene Asetuksiin, Lisenssit
Gå til Innstillinger, Lisenser

Scan the license
Skanna licensen
Skannaa lisenssi
Skann lisensen

Add new Reporter
Lägg till ny Rapportör
Lisää uusi Reporters
Legg til ny Reporter.

Fill in information, Save
Fyll i fälten, Spara
Täytä kentät, Tallenna
Fyll ut feltene, Lagre

LED Color Indication

Status Indication:

- **Connection OK**
Anslutning OK
Yhteys OK
Tilkobling OK
- ☀ **Connecting To Router**
Ansluter Till Router
Yhdistää reitittimeen
Kobler til ruteren
- ☀ **Connecting To Wi-Fi**
Ansluter Till Wi-Fi
Yhdistää Wi-Fiin
Kobler til Wi-Fi
- ☀ **Configuration Mode**
Konfigurationsläge
Konfiguraatiotila
Konfigurasjonsmodus
- ☀ **Incorrect Wi-Fi Password**
Fel Wi-Fi-lösenord
Virheellinen Wi-Fi-salasana
Feil Wi-Fi-passord



Configuration Mode ON/OFF:

- Press and hold **A** for ~10 seconds
- Tryck och håll in **A** i ~10 sekunder
- Pidä painiketta painettuna noin **A** 10 sekuntia.
- Trykk og hold inne **A** i ca. 10 sekunder

Integration Guides



Find guides for how to set up specific EV chargers.

Se alla guider för kompatibla elbilsaddare.

Katso oppaat yhteensopiville sähköauton latauslaitteille.

Se alle guider for compatible elbil-ladere.



en.perific.com/downloads

Need any help?

Thank you for choosing Perific.
If you have any questions or need help,
please do not hesitate to contact us.

support@perific.com



FAQ / Videos

Quick Start Guide V2.2

Product
Max

Measuring Methods
HAN/P1 RJ12 | HAN/P1 RJ45
| Sensor compatible (L1-L4)

Languages
🇬🇧 EN 🇸🇪 SV, 🇳🇴 NO, 🇫🇮 FI, 🇩🇰 NO,

Quick Start Guide

PERIFIC
max